

Working height 900mm on request

Alternative detail for 800 deep tabling

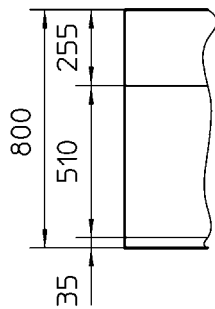

* Minimum table length

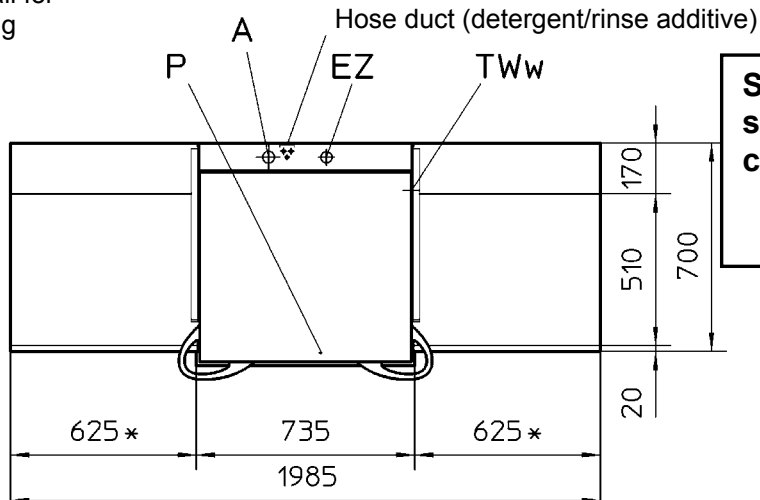

Site connections should be adjacent to machine.



For further installation details see page 2

Special instructions:		All electrical and hydraulic connection works must be executed according to local and national regulations. Site connections should be adjacent to machine. Only with switched off main switch (on-site) the machine is without voltage.		
P	Connection point for equipotential bonding system			
EZ	Electrical connection • 3N~ • 3~	Total Load		Site to supply main switch and fuses in accordance to the connecting load. Cable length approx. 2 m from point TWw. Machine has to be included in the equipotential bonding system.
			Water supply temperature	
		9.6kW	40°C-60°C	
	15.6kW	Approx. 10°C-40°C		
TWw	Water connection G ¾"; max. 60°C 0,8-6 bar (80-600kPa); approx. 5 l/min		Supplied with flexible connection hose. Length approx. 2.0m from rear of machine. Stop valve required on site.	
A	Water drainage with drain pump	Flexible hose DN 40/50. Length approx. 1.5m from rear of machine. Drainage height max. 650mm, siphon on site. Otherwise order conversion kit 55 28 261 (with drainage hose DN25). Then max. drainage height is 1.5m.		
89006789-05 / Page 1		Connection diagram Dishwasher GS 515		winterhalter
Drawn up: 26.09.00 sch altered: 08.04.04 sch				

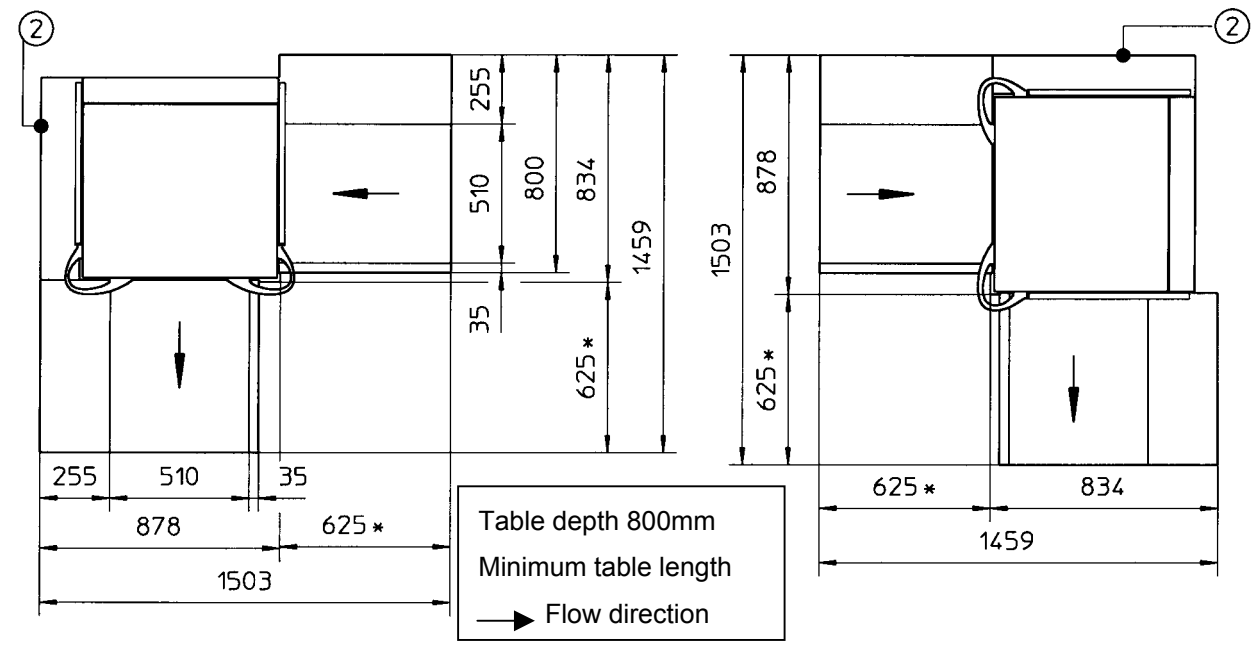
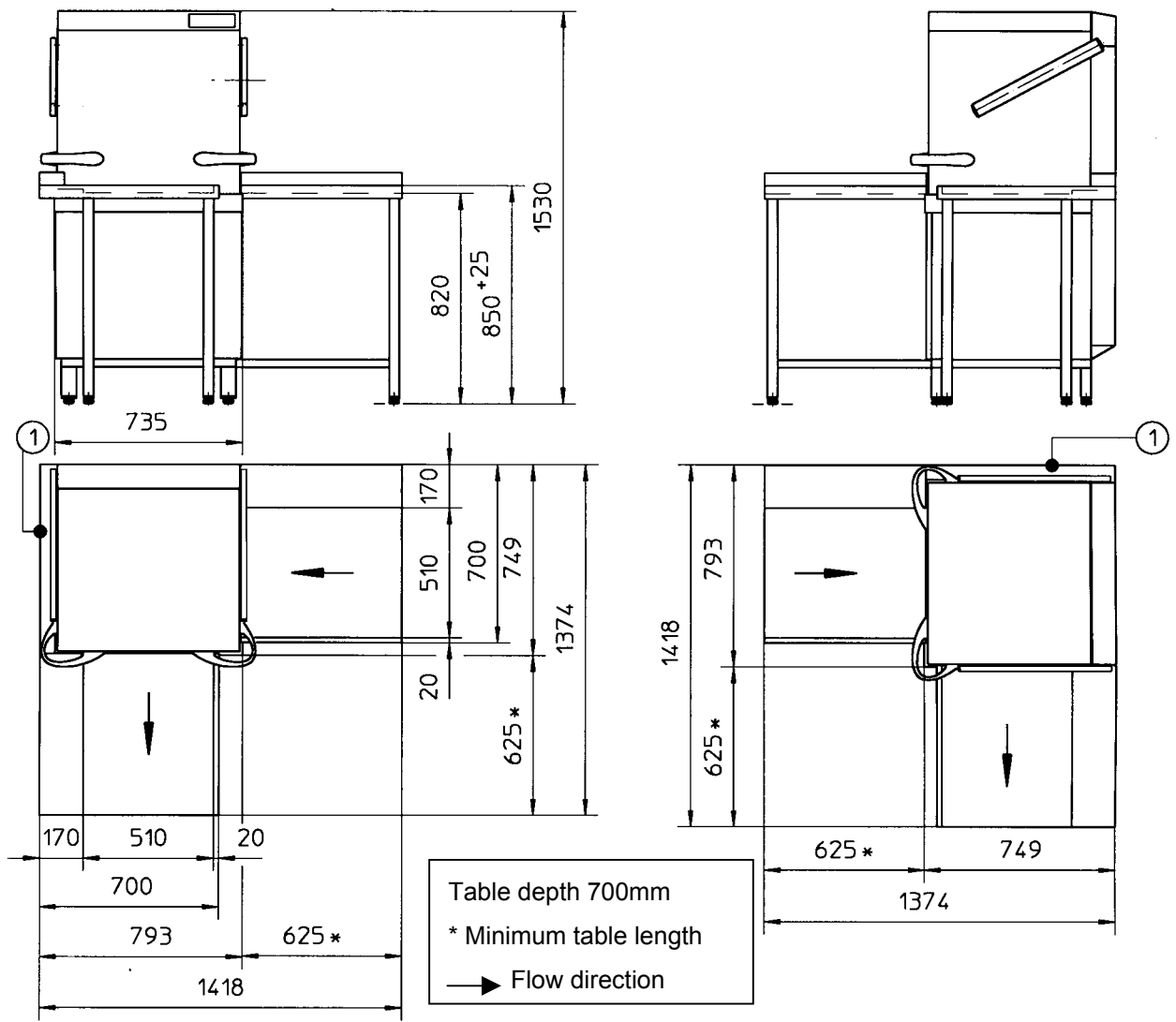

Item	Wall end plate for...	Parts no.
①	... table depth 700mm	75201158
②	... table depth 800mm	75201159